



TITLE: PROCEDURE, LEGEND REPLACEMENT, SERIES 92 PUSHBUTTON

PURPOSE:

To provide sufficient information and instruction to the customer to enable him/her to replace legend plates on Types 8 and 9 displays "in the field."

SCOPE:

Covers procedure for disassembly, installation and reassembly. Also covers physical requirements of the replacement legend plate. Does not cover how to make a replacement legend plate.

TOOLS:

No special tools required. Recommend razor blade or scissors for cutting plastic film and scale graduated in .020" increments maximum (.5mm.).

PROCEDURE:

Disassembly: (Ref. Figure I)

Slip fingernail under lip of bezel (either side), pull outward and lift up over retainer tab. Set lower assembly aside.

Place bezel on flat surface, right side up, and press display stack, including seal, down out of bezel.

Remove seal from display stack.

You now have three separate parts, 1) Face Screen, 2) Legend Plate and 3) Lens Diffuser Plate.

Note the orientation of the three parts as you set them aside as they will need to be arranged in the same orientation on reassembly.

Slide out the old legend plate and insert the new one in its place between the Face Screen and the Diffuser Plate being sure to orient the legend in the same direction as the original one.

NOTE: Refer to the illustration of the legend plate shown in Figure II which shows the size, shape and area boundaries for the new legend.

The information and design disclosed herein was originated by and is the property of STACOSWITCH, INC. STACOSWITCH, INC. reserves all patent, proprietary, design, manufacturing, reproduction, use and sale rights thereto, and to any article disclosed therein, except to the extent rights are expressly granted to others. The foregoing does not apply to vendor proprietary parts.



Reassembly:

Slip the rubber seal over the three piece display stack, either side up, and no special orientation required as it is square. Make sure all four edges on both sides are overlapping the Display Screen stack properly.

Place the bezel on flat surface bottom side up. Spread the four walls of the bezel very slightly to help accept the Seal and Display Stack more readily. Note that the bezel can be installed in either of two 180° positions as the part is symmetrical about a centerline.

Drop one edge of the Seal/Faceplate assembly and install it all the way down and under one of the retainer tab holes. Then press the other edge of the assembly down into the bezel making sure the rubber seal does not snag on the edge of the bezel wall. The fingernail can serve as sort of a "shoehorn" to assist in getting the seal to slide down smoothly inside the bezel wall. Press Seal/Display down firmly to bottom of bezel.

Pick up lower pushbutton assembly and orient the open lampbox toward you, the detent away from you and the index post away from you at 12:00 position (i.e., P/B in right side up orientation). Hold in left hand.

Pick up Bezel/Seal/Display stack assembly in right hand, orient the Face Screen toward you with the legend right side up.

Hook one side of bezel over its retention tab on the lower assembly, then rock bezel over onto the top of the lamp box and press home until both sides of bezel are snapped in place. Run your fingernail along under each retainer tab to press the lip of the bezel well under the retention tab to assure the pushbutton assembly is securely locked together. Pushbutton is now ready to be reinstalled in the switch assembly.



SACO SWITCH
 A COMPONENTS CORPORATION OF AMERICA COMPANY
 1139 BAKER STREET COSTA MESA, CALIF. 92626
 (714)549-3041 TWX: 910/595-1507

ASSEMBLED PUSHBUTTON
 READY TO BE INSTALLED IN
 SWITCH ASSEMBLY

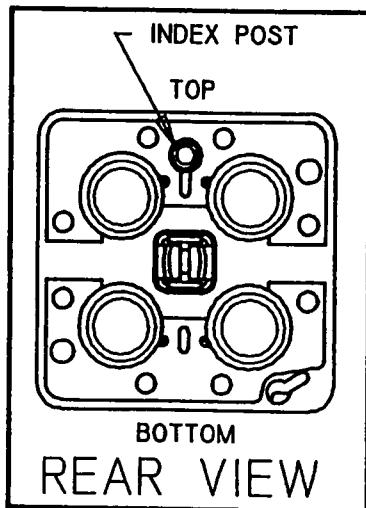
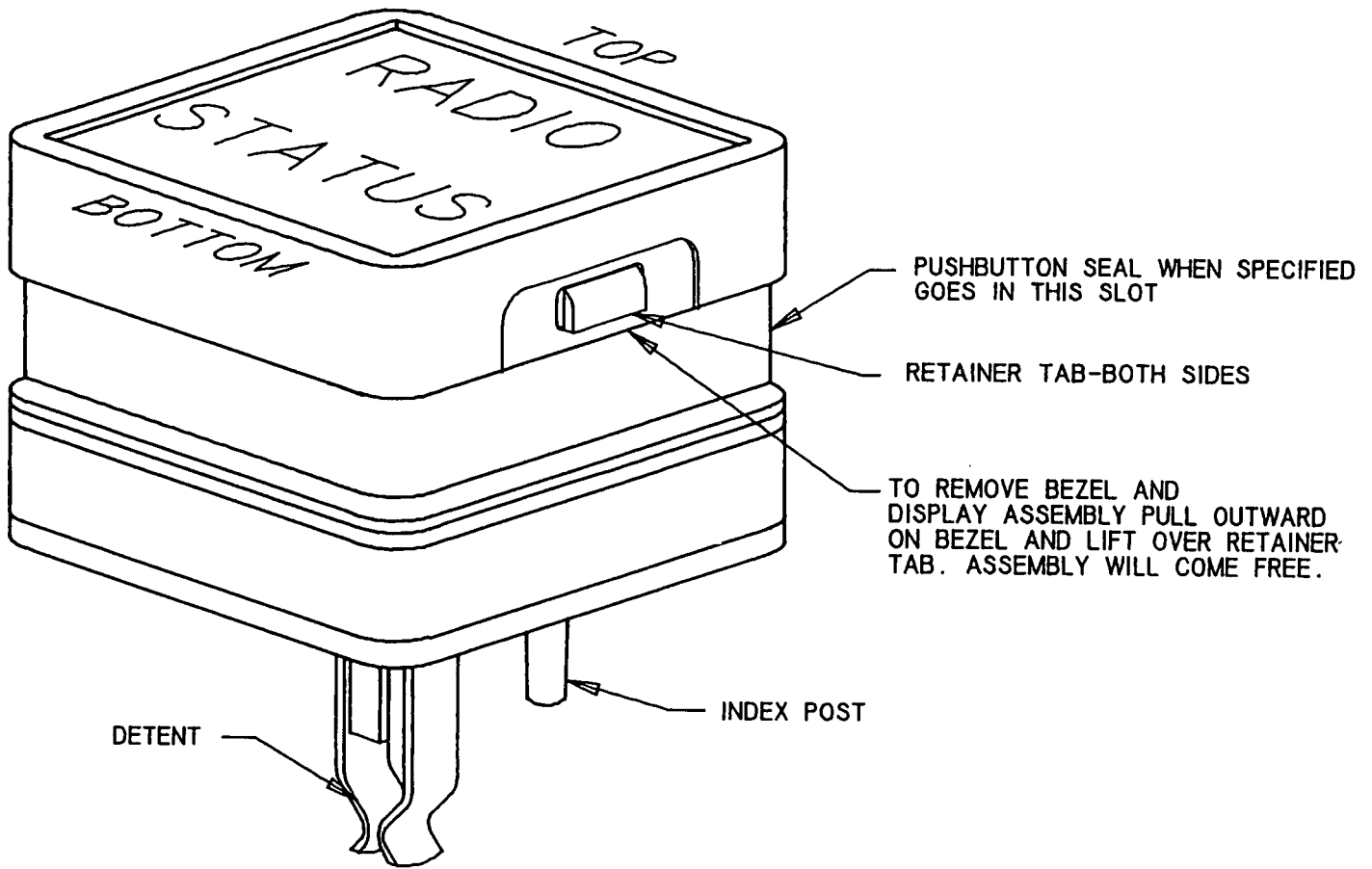

FIGURE I

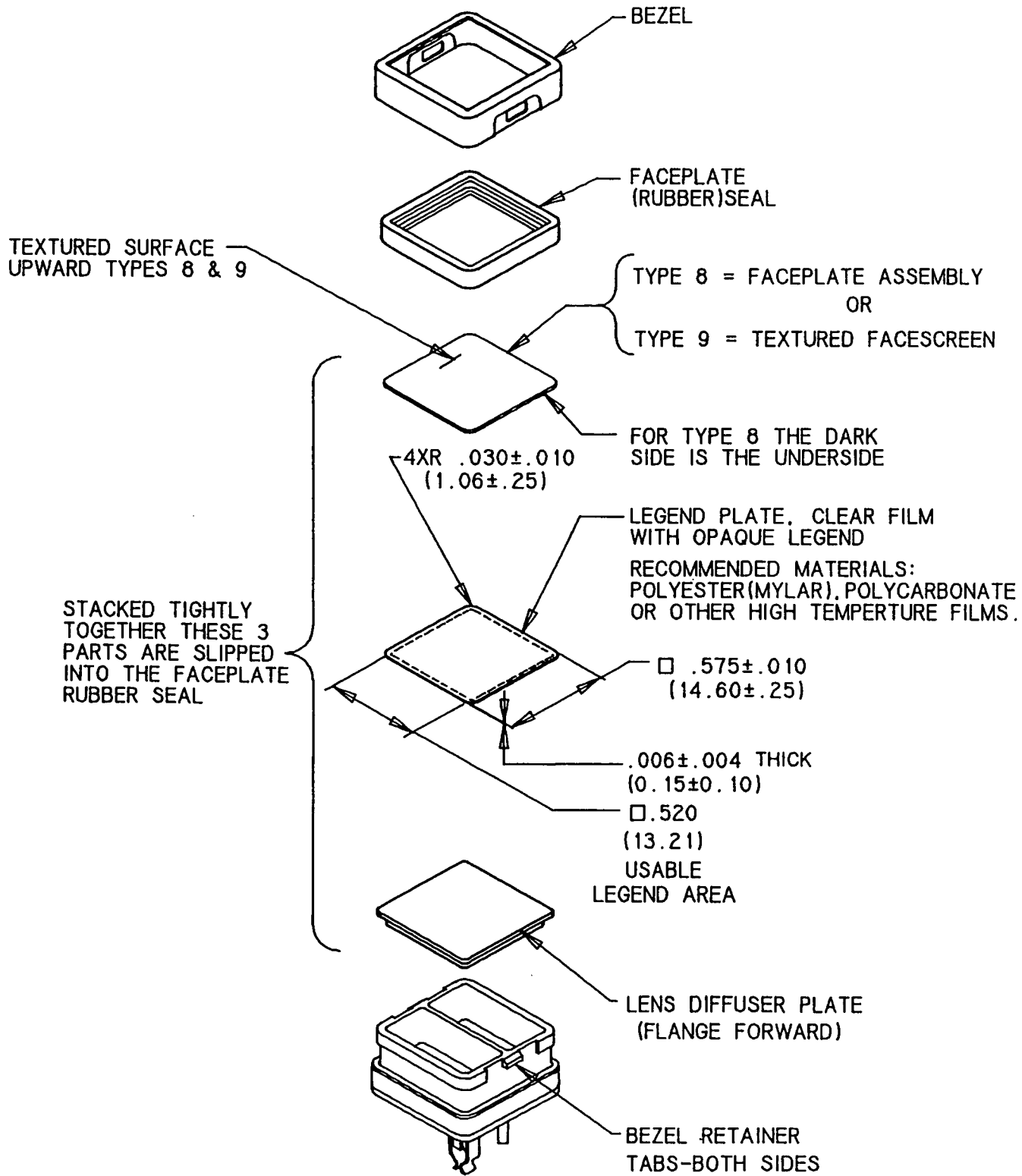

FIGURE II

REV-A 10\87